

THE VALUE OF ARCHITECTURE.

Brian Linder, AIA
www.tvoa.net

PH - 800.684.8862
FX - 310.861.8953

OPEN SUNDAY - January 20th, 1 - 4pm
Gray Matter Architecture



Photography by: Eric Staudenmaier Photography

Melinda Gray, AIA

825 Milwood Avenue - Venice

[View Map](#)

Just completed, architecturally designed, environmentally sensitive Venice domicile with separate studio above garage. The elements of polished concrete floors, exposed structural beams hardwood surfaces inside & out, combine warmth & hard lines successfully creating an elastic, private space. The high end open kitchen and oversized center island anchors the primary level. Two story glass door systems dramatically eliminate any boundary between the interior & the exterior. The second floor opens to the primary level integrating the public & private spaces. A fully outfitted open basement supplies another dimension. A flex space above the garage successfully creates the exterior courtyard between the two buildings. This is a rare example of successful orchestration in design, quality and craftsmanship. The main structure is powered by the photovoltaic solar system.

Listing Agents:

Frank Langen & Diana Braun

Deasy Penner & Partners

Offered at \$2,390,000

Status	Active
Type	Single Family
Bedrooms	3
Baths	4
Lot Size	4,375 sf

For more information contact :
Brian Linder, AIA Realtor
800-684-8862

Please visit our online gallery
and featured architect:
Gray Matter Architecture

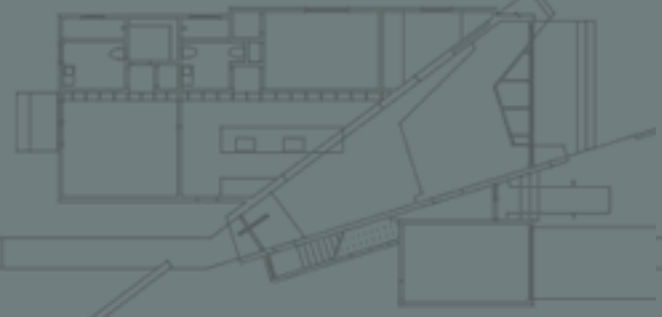

tvoa.net

Properties with Design Integrity
150 South Rodeo Drive, Suite 230
Beverly Hills, California 90212

TheValueOfArchitecture.net